

## Coupling socket, quick coupling plug KD

**FESTO**

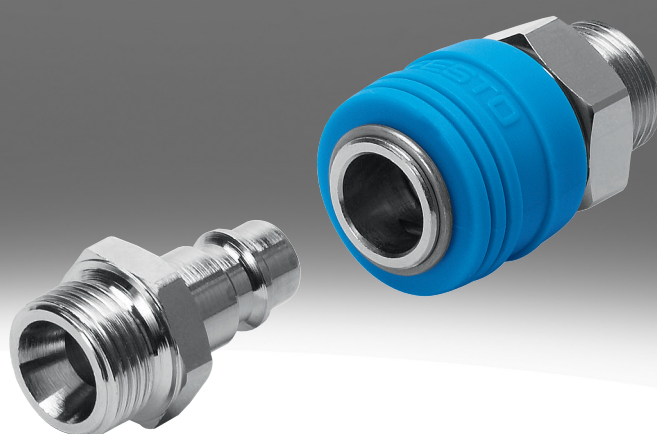

## Characteristics

### At a glance

Coupling to ISO 4414, with shut-off on one side or both sides.

- Quick connection coupling for standard applications without safety function
- Shut off at one or both ends
- With male or female thread or with barbed connector or quick connector
- Nickel-plated brass, PP
- Operating medium: compressed air, vacuum

Notes on product selection:

- All coupling sockets of the same size are compatible with all plugs of this size.
- Coupling sockets KD4 can be combined with all quick coupling plugs NPHS-S6. For couplings that are frequently subject to pressure surges or that have to be frequently mated, it is recommended to use the hardened quick coupling plugs NPHS-S6.

### Coupling element

[D] Coupling socket

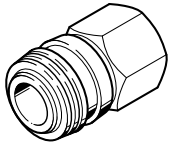

[S] Coupling plug

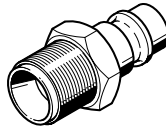

### Additional function

[R] Self-locking

When used with the quick coupling plug KS...-A-R, the coupling KD...-A-R has a shut-off function on both sides. It is possible to use other plugs, but the function would then correspond to the KD...-A coupling with shut-off on one side and reduced cross-section.

It is not advisable to use the quick coupling plug KS...-A-R with other couplings, as, when it is plugged in, the valve in the plug is not opened.

## Type code

001	Series
<b>KD</b>	Coupling socket
<b>KS</b>	Coupling plug

002	Coupling size
<b>1</b>	Size 1
<b>2</b>	Size 2
<b>3</b>	Size 3
<b>4</b>	Size 4

003	Connection type
	Thread
<b>CK</b>	Quick connector CK
<b>CN</b>	Barbed connector CN
<b>N</b>	Barbed connector N

004	Connection size
<b>1/8</b>	1/8
<b>1/4</b>	1/4
<b>3/8</b>	3/8
<b>1/2</b>	1/2
<b>2</b>	2 mm
<b>3</b>	3 mm
<b>4</b>	4 mm
<b>6</b>	6 mm
<b>9</b>	9 mm
<b>M3</b>	M3
<b>M5</b>	M5

005	Connection design
	Standard
<b>A</b>	Outside
<b>I</b>	Inside

006	Additional function
	None
<b>R</b>	Self-locking

## Datasheet

**Technical data – Coupling sockets NPHS-D6-M (unlocking sleeve metal)**

Short type code	KD1
Pneumatic connection, port 1	Male thread M3
Nominal size	1.5 mm
Nominal torque	0.6 Nm
Tolerance for nominal tightening torque	± 10%
Standard nominal flow rate <sup>1)</sup>	44 l/min
Nominal flow rate standardised according to ISO 8778	47.7 l/min
Operating pressure complete temperature range	-0.095 ... 1.2 MPa
Operating pressure complete temperature range	-0.95 ... 12 bar
Operating pressure complete temperature range	-13.775 ... 174 psi
Operating medium	Compressed air to ISO 8573-1:2010 [7:::]
Note on operating and pilot medium	Lubricated operation possible
Ambient temperature	-10 ... 60°C
Corrosion resistance class CRC <sup>2)</sup>	1 - Low corrosion stress
Material housing	Brass, nickel-plated
Material releasing sleeve	Nickel-plated brass
Valve body material	Brass
Material seals	NBR
Material spring	High-alloy stainless steel
Material thread seal	NBR, High-alloy stainless steel
Material thread piece	Nickel-plated brass
Material ball	High-alloy stainless steel
Note on materials	RoHS-compliant
LABS (PWIS) conformity	VDMA24364-B1/B2-L

1) Measured at p<sub>1</sub> = 6 bar and Δp = 1 bar

2) More information [www.festo.com/x/topic/crc](http://www.festo.com/x/topic/crc)

**Technical data – Coupling sockets NPHS-D6-M (unlocking sleeve metal)**

Short type code	KS1
Pneumatic connection, port 1	Barbed hose fitting 2 mm
Nominal size	1.5 mm
Standard nominal flow rate <sup>1)</sup>	44 l/min
Nominal flow rate standardised according to ISO 8778	47.7 l/min
Operating pressure complete temperature range	-0.095 ... 1.2 MPa
Operating pressure complete temperature range	-0.95 ... 12 bar
Operating pressure complete temperature range	-13.775 ... 174 psi
Operating medium	Compressed air to ISO 8573-1:2010 [7:::]
Note on operating and pilot medium	Lubricated operation possible
Ambient temperature	-10 ... 60°C
Corrosion resistance class CRC <sup>2)</sup>	1 - Low corrosion stress
Information on materials	Brass, nickel plated
Note on materials	RoHS-compliant
LABS (PWIS) conformity	VDMA24364-B1/B2-L

1) Measured at p<sub>1</sub> = 6 bar and Δp = 1 bar

2) More information [www.festo.com/x/topic/crc](http://www.festo.com/x/topic/crc)

## Datasheet

Technical data – Coupling sockets NPHS-D6-M (unlocking sleeve metal)				
Short type code	KD2			
Pneumatic connection, port 1	Male thread M5	Female thread M5	For tubing outer diameter of 4 mm, For barbed fitting I.D. 3 mm with union nut	CK-4, For barbed fitting I.D. 4 mm with union nut
Nominal size	2.4 mm	2.7 mm	2 mm	2.9 mm
Nominal torque	0.85 Nm		–	
Tolerance for nominal tightening torque	± 15%		–	
Standard nominal flow rate <sup>1)</sup>	83 ... 131 l/min	84 ... 135 l/min	68 ... 88 l/min	82 ... 130 l/min
Nominal flow rate standardised according to ISO 8778	90 ... 142 l/min	91.1 ... 146.3 l/min	73.7 ... 95.4 l/min	88.9 ... 140.9 l/min
Operating pressure complete temperature range	-0.095 ... 1.2 MPa			
Operating pressure complete temperature range	-0.95 ... 12 bar			
Operating pressure complete temperature range	-13.775 ... 174 psi			
Operating medium	Compressed air to ISO 8573-1:2010 [7:::]			
Note on operating and pilot medium	Lubricated operation possible			
Ambient temperature	-10 ... 60°C			
Corrosion resistance class CRC <sup>2)</sup>	1 - Low corrosion stress			
Material housing	Brass, nickel-plated			
Material releasing sleeve	Nickel-plated brass			
Valve body material	Brass			
Material seals	NBR			
Material spring	High-alloy stainless steel			
Material thread seal	NBR, High-alloy stainless steel	–		
Material thread piece	Nickel-plated brass		–	
Material snap ring	High-alloy stainless steel			
Material ball	High-alloy stainless steel			
Material union nut	–		Nickel-plated wrought aluminium alloy	
Note on materials	RoHS-compliant			
LABS (PWIS) conformity	VDMA24364-B1/B2-L			

1) Measured at p1 = 6 bar and Δp = 1 bar

2) More information [www.festo.com/x/topic/crc](http://www.festo.com/x/topic/crc)

## Datasheet

Technical data – Coupling sockets NPHS-D6-M (unlocking sleeve metal)				
Short type code	KS2			
Pneumatic connection, port 1	Male thread M5	Female thread M5	For tubing outer diameter of 4 mm, For barbed fitting I.D. 3 mm with union nut	For tubing outside diameter of 6 mm, For barbed fitting I.D. 4 mm with union nut
Nominal size	2.4 mm	2.7 mm	2 mm	2.7 mm
Nominal torque	0.85 Nm		–	
Tolerance for nominal tightening torque	± 15%		–	
Standard nominal flow rate <sup>1)</sup>	85 ... 136 l/min	88 ... 139 l/min	68 ... 84 l/min	86 ... 129 l/min
Nominal flow rate standardised according to ISO 8778	92.1 ... 147.4 l/min	95.4 ... 150.7 l/min	73.7 ... 91.1 l/min	93.2 ... 139.8 l/min
Operating pressure complete temperature range	-0.095 ... 1.2 MPa			
Operating pressure complete temperature range	-0.95 ... 12 bar			
Operating pressure complete temperature range	-13.775 ... 174 psi			
Operating medium	Compressed air to ISO 8573-1:2010 [7:-:-]			
Note on operating and pilot medium	Lubricated operation possible			
Ambient temperature	-10 ... 60°C			
Corrosion resistance class CRC <sup>2)</sup>	1 - Low corrosion stress			
Material thread seal	NBR, High-alloy stainless steel	–		
Material union nut	–		Nickel-plated wrought aluminium alloy	
Information on materials	Brass, nickel plated			
Note on materials	RoHS-compliant			
LABS (PWIS) conformity	VDMA24364-B1/B2-L			

1) Measured at p<sub>1</sub> = 6 bar and Δp = 1 bar

2) More information [www.festo.com/x/topic/crc](http://www.festo.com/x/topic/crc)

## Datasheet

Technical data – Coupling sockets NPHS-D6-M (unlocking sleeve metal)						
Short type code	KD3					
Pneumatic connection, port 1	Male thread G1/8	Male thread G1/4	Female thread G1/8	Female thread G1/4	For tubing outside diameter of 6 mm, For barbed fitting I.D. 4 mm with union nut	For tubing outer diameter of 8 mm, For barbed fitting I.D. 6 mm with union nut
Nominal size	4.95 mm	5 mm		2.9 mm		4.9 mm
Nominal torque	5 Nm	9.5 Nm	5 Nm	9.5 Nm	–	
Tolerance for nominal tightening torque	± 15%				–	
Standard nominal flow rate <sup>1)</sup>	185 ... 572 l/min	185 ... 594 l/min	185 ... 603 l/min	185 ... 666 l/min	158 ... 225 l/min	180 ... 468 l/min
Nominal flow rate standardised according to ISO 8778	200.5 ... 620 l/min	200.5 ... 643.9 l/min	200.5 ... 653.7 l/min	200.5 ... 721.9 l/min	171.3 ... 243.9 l/min	195.1 ... 507.3 l/min
Operating pressure complete temperature range	-0.095 ... 1.2 MPa					
Operating pressure complete temperature range	-0.95 ... 12 bar					
Operating pressure complete temperature range	-13.775 ... 174 psi					
Operating medium	Compressed air to ISO 8573-1:2010 [7:-:-]					
Note on operating and pilot medium	Lubricated operation possible					
Ambient temperature	-10 ... 60°C					
Corrosion resistance class CRC <sup>2)</sup>	1 - Low corrosion stress					
Material housing	Brass, nickel-plated					
Material releasing sleeve	Nickel-plated brass					
Valve body material	Brass					
Material seals	NBR					
Material spring	High-alloy stainless steel					
Material thread seal	PA66-GF30/TPE-U		–			
Material thread piece	Nickel-plated brass			–		
Material snap ring	High-alloy stainless steel					
Material ball	High-alloy stainless steel					
Material union nut	–				Nickel-plated wrought aluminium alloy	
Note on materials	RoHS-compliant					
LABS (PWIS) conformity	VDMA24364-B1/B2-L					

1) Measured at p1 = 6 bar and Δp = 1 bar

2) More information [www.festo.com/x/topic/crc](http://www.festo.com/x/topic/crc)

## Datasheet

## Technical data – Coupling sockets NPHS-D6-M (unlocking sleeve metal)

Short type code	KS3					
Pneumatic connection, port 1	Male thread G1/8	Male thread G1/4	Female thread G1/8	Female thread G1/4	CK-4, For barbed fitting I.D. 4 mm with union nut	For tubing outer diameter of 8 mm, For barbed fitting I.D. 6 mm with union nut
Nominal size	4.95 mm				2.9 mm	4.9 mm
Nominal torque	5 Nm	9.5 Nm	5 Nm	9.5 Nm	–	
Tolerance for nominal tightening torque	± 15%				–	
Standard nominal flow rate <sup>1)</sup>	225 ... 648 l/min	225 ... 653 l/min	225 ... 617 l/min	225 ... 666 l/min	158 ... 185 l/min	216 ... 464 l/min
Nominal flow rate standardised according to ISO 8778	243.9 ... 702.4 l/min	243.9 ... 707.9 l/min	243.9 ... 668.8 l/min	243.9 ... 721.9 l/min	171.3 ... 200.5 l/min	234.1 ... 503 l/min
Operating pressure complete temperature range	-0.095 ... 1.2 MPa					
Operating pressure complete temperature range	-0.95 ... 12 bar					
Operating pressure complete temperature range	-13.775 ... 174 psi					
Operating medium	Compressed air to ISO 8573-1:2010 [7:::]					
Note on operating and pilot medium	Lubricated operation possible					
Ambient temperature	-10 ... 60°C					
Corrosion resistance class CRC <sup>2)</sup>	1 - Low corrosion stress					
Material thread seal	PA66-GF30/TPE-U	–				
Material union nut	–				Nickel-plated wrought aluminium alloy	
Information on materials	Brass, nickel plated					
Note on materials	RoHS-compliant					
LABS (PWIS) conformity	VDMA24364-B1/B2-L					

1) Measured at p<sub>1</sub> = 6 bar and Δp = 1 bar

2) More information [www.festo.com/x/topic/crc](http://www.festo.com/x/topic/crc)



## Datasheet

Technical data – Coupling sockets NPHS-D6-M (unlocking sleeve metal)										
Short type code	KD4									
Pneumatic connection, port 1	Male thread G1/4	Male thread G3/8	Male thread G1/2	Female thread G1/4	Female thread G3/8	Female thread G1/2	For tubing outer diameter of 8 mm, For barbed fitting I.D. 6 mm with union nut	For barbed fitting inside diameter of 9 mm with union nut	Barbed hose fitting 9 mm	
Nominal size	8 mm	10 mm		7.2 mm			4.9 mm	7.4 mm		
Nominal torque	9.5 Nm	21.5 Nm	32.5 Nm	9.5 Nm	21.5 Nm	32.5 Nm	–			
Tolerance for nominal tightening torque	± 15%		± 20%	± 15%			± 20%	–		
Standard nominal flow rate <sup>1)</sup>	261 ... 1,287 l/min	261 ... 1,274 l/min	257 ... 1,337 l/min	257 ... 1,292 l/min	261 ... 1,350 l/min	257 ... 1,332 l/min	252 ... 756 l/min	261 ... 1,116 l/min	810 ... 1,152 l/min	
Nominal flow rate standardised according to ISO 8778	282.9 ... 1,395.1 l/min	282.9 ... 1,381 l/min	278.6 ... 1,449.3 l/min	278.6 ... 1,400.5 l/min	282.9 ... 1,463.4 l/min	278.6 ... 1,443.9 l/min	273.2 ... 819.5 l/min	282.9 ... 1,209.7 l/min	878 ... 1,248.8 l/min	
Operating pressure complete temperature range	-0.095 ... 1.2 MPa									
Operating pressure complete temperature range	-0.95 ... 12 bar									
Operating pressure complete temperature range	-13.775 ... 174 psi									
Operating medium	Compressed air to ISO 8573-1:2010 [7:-:-]									
Note on operating and pilot medium	Lubricated operation possible									
Ambient temperature	-10 ... 60°C									
Corrosion resistance class CRC <sup>2)</sup>	1 - Low corrosion stress									
Material housing	Brass, nickel-plated									
Material releasing sleeve	PP									
Valve body material	Brass									
Material seals	NBR									
Material spring	High-alloy stainless steel									
Material thread seal	PA66-GF30/TPE-U			–						
Material thread piece	Nickel-plated brass						–			
Material of inner raceway	Brass									
Material snap ring	High-alloy stainless steel									
Material pins	High-alloy stainless steel									
Material union nut	–						Nickel-plated wrought aluminium alloy		–	
Note on materials	RoHS-compliant									
LABS (PWIS) conformity	VDMA24364-B1/B2-L									

1) Measured at p1 = 6 bar and Δp = 1 bar

2) More information [www.festo.com/x/topic/crc](http://www.festo.com/x/topic/crc)

## Datasheet

## Technical data – Coupling sockets NPHS-D6-M (unlocking sleeve metal)

Short type code	KS4										
Pneumatic connection, port 1	Male thread G1/4	Male thread G3/8	Male thread G1/2	Female thread G1/4	Female thread G3/8	Female thread G1/2	For tubing outside diameter of 6 mm, For barbed fitting I.D. 4 mm with union nut	For tubing outer diameter of 8 mm, For barbed fitting I.D. 6 mm with union nut	For barbed fitting inside diameter of 9 mm with union nut	Barbed hose fitting 6 mm	Barbed hose fitting 9 mm
Nominal size	7.85 mm						2.9 mm	4.9 mm	7.4 mm	4.5 mm	7 mm
Nominal torque	9.5 Nm	21.5 Nm	32.5 Nm	9.5 Nm	21.5 Nm	32.5 Nm	–				
Tolerance for nominal tightening torque	± 15%		± 20%	± 15%		± 20%	–				
Standard nominal flow rate <sup>1)</sup>	756 ... 1,323 l/min			720 ... 1,161 l/min	756 ... 1,350 l/min	756 ... 1,314 l/min	252 ... 261 l/min	432 ... 495 l/min	725 ... 1,197 l/min	441 ... 495 l/min	711 ... 1,134 l/min
Nominal flow rate standardised according to ISO 8778	819.5 ... 1,434.1 l/min			780.5 ... 1,258.5 l/min	819.5 ... 1,463.4 l/min	819.5 ... 1,424.4 l/min	273.2 ... 282.9 l/min	468.3 ... 536.6 l/min	785.9 ... 1,297.5 l/min	478 ... 536.6 l/min	770.7 ... 1,229.3 l/min
Operating pressure complete temperature range	-0.095 ... 1.2 MPa										
Operating pressure complete temperature range	-0.95 ... 12 bar										
Operating pressure complete temperature range	-13.775 ... 174 psi										
Operating medium	Compressed air to ISO 8573-1:2010 [7:::]										
Note on operating and pilot medium	Lubricated operation possible										
Ambient temperature	-10 ... 60°C										
Corrosion resistance class CRC <sup>2)</sup>	1 - Low corrosion stress										
Material thread seal	PA66-GF30/TPE-U			–							
Material union nut	–						Nickel-plated wrought aluminium alloy		–		
Information on materials	Brass, nickel plated										
Note on materials	RoHS-compliant										
LABS (PWIS) conformity	VDMA24364-B1/B2-L										

1) Measured at p<sub>1</sub> = 6 bar and Δp = 1 bar2) More information [www.festo.com/x/topic/crc](http://www.festo.com/x/topic/crc)

## Datasheet

Technical data – Coupling sockets NPHS-D6-M (unlocking sleeve metal)		
Short type code	KD3	KD4
Pneumatic connection, port 1	Male thread G1/8	Male thread G1/4
Nominal size	5 mm	8 mm
Nominal torque	5 Nm	9.5 Nm
Tolerance for nominal tightening torque	± 15%	
Standard nominal flow rate <sup>1)</sup>	–	765 l/min
Nominal flow rate standardised according to ISO 8778	–	829.3 l/min
Operating pressure complete temperature range	-0.095 ... 1.2 MPa	
Operating pressure complete temperature range	-0.95 ... 12 bar	
Operating pressure complete temperature range	-13.775 ... 174 psi	
Operating medium	Compressed air to ISO 8573-1:2010 [7:-:]	
Note on operating and pilot medium	Lubricated operation possible	
Ambient temperature	-10 ... 60°C	
Corrosion resistance class CRC <sup>2)</sup>	1 - Low corrosion stress	
Material housing	Brass	
Material releasing sleeve	Nickel-plated brass	PP
Valve body material	Brass	
Material seals	NBR	
Material spring	High-alloy stainless steel	
Material thread seal	PA66-GF30/TPE-U	
Material thread piece	Brass	
Material of inner raceway	–	Brass
Material snap ring	High-alloy stainless steel	
Material pins	–	High-alloy stainless steel
Material ball	High-alloy stainless steel	–
Note on materials	RoHS-compliant	
LABS (PWIS) conformity	VDMA24364-B1/B2-L	

1) Measured at p<sub>1</sub> = 6 bar and Δp = 1 bar

2) More information [www.festo.com/x/topic/crc](http://www.festo.com/x/topic/crc)

## Datasheet

Technical data – Coupling sockets NPHS-D6-M (unlocking sleeve metal)		
Short type code	KS3	KS4
Pneumatic connection, port 1	Male thread G1/8	Male thread G1/4
Nominal size	4.2 mm	8 mm
Nominal torque	5 Nm	9.5 Nm
Tolerance for nominal tightening torque	± 15%	
Standard nominal flow rate <sup>1)</sup>	–	765 l/min
Nominal flow rate standardised according to ISO 8778	–	829.3 l/min
Operating pressure complete temperature range	-0.095 ... 1.2 MPa	
Operating pressure complete temperature range	-0.95 ... 12 bar	
Operating pressure complete temperature range	-13.775 ... 174 psi	
Operating medium	Compressed air to ISO 8573-1:2010 [7:::]	
Note on operating and pilot medium	Lubricated operation possible	
Ambient temperature	-10 ... 60°C	
Corrosion resistance class CRC <sup>2)</sup>	1 - Low corrosion stress	
Valve body material	Brass	
Material seals	NBR	
Material spring	High-alloy stainless steel	
Material thread seal	PA66-GF30/TPE-U	
Information on materials	Brass	
Note on materials	RoHS-compliant	
LABS (PWIS) conformity	VDMA24364-B1/B2-L	

1) Measured at p1 = 6 bar and Δp = 1 bar

2) More information [www.festo.com/x/topic/crc](http://www.festo.com/x/topic/crc)

## Dimensions

## Dimensions – Coupling socket KD1, male thread

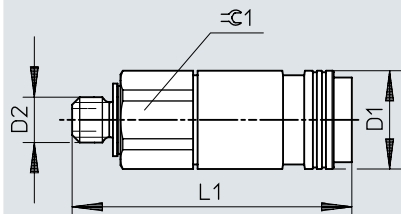
Download CAD data → [www.festo.com](http://www.festo.com)

	D1 ∅	D2	L1	=G 1
KD1-M3-A	6,5	M3	18,5	6

## Dimensions

Dimensions – Quick coupling plug KS1, barbed fitting

Download CAD data → [www.festo.com](http://www.festo.com)

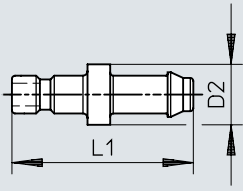

	D2	L1
KS1-CN-2	4	12

## Dimensions

Dimensions – Plug-in coupling KD1/KS1, insertion depth

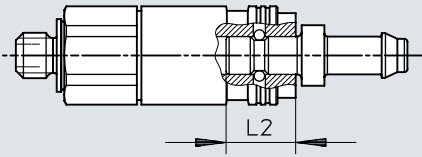
Download CAD data → [www.festo.com](http://www.festo.com)

	L2
KD1-M3-A	4,6
KS1-CN-2	4,6

## Dimensions

### Dimensions – Coupling socket KD2, male thread

Download CAD data → [www.festo.com](http://www.festo.com)

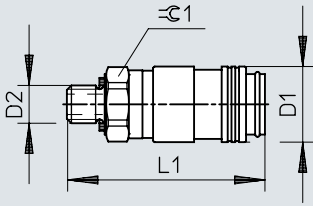

	D1 ∅	D2	L1	±0.1
KD2-M5-A	10	M5	26,25	9



## Dimensions

## Dimensions – Coupling socket KD2, female thread

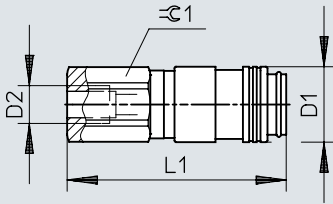
Download CAD data → [www.festo.com](http://www.festo.com)

	D1 ∅	D2	L1	$\pm 0.1$
KD2-M5-I	10	M5	29,05	9

## Dimensions

### Dimensions – Coupling socket KD2, quick connector

Download CAD data → [www.festo.com](http://www.festo.com)

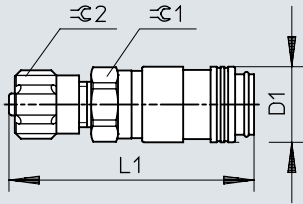

	D1 ∅	L1	∅ 1	∅ 2
KD2-CK-3	10	32,55	9	8
KD2-CK-4	10	35,75	11	12

## Dimensions

## Dimensions – Quick coupling plug KS2, male thread

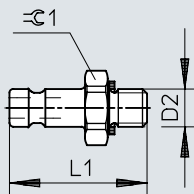
Download CAD data → [www.festo.com](http://www.festo.com)

	D2	L1	±0.1
KS2-M5-A	M5	18,2	9

## Dimensions

### Dimensions – Quick coupling plug KS2, female thread

Download CAD data → [www.festo.com](http://www.festo.com)

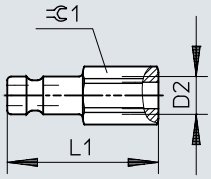

	D2	L1	≈ 1
KS2-M5-I	M5	20	7

## Dimensions

## Dimensions – Quick coupling plug KS2, quick connector

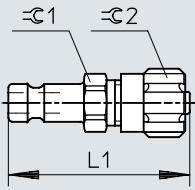
Download CAD data → [www.festo.com](http://www.festo.com)

	L1	$\varnothing 1$	$\varnothing 2$
KS2-CK-3	24	7	8
KS2-CK-4	27,2	11	12

## Dimensions

Dimensions – Quick coupling plug KS2, insertion depth

Download CAD data → [www.festo.com](http://www.festo.com)

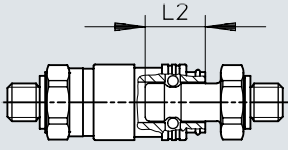

	L2
KS2-M5-A	7,95
KS2-M5-I	7,95
KS2-CK-3	7,95
KS2-CK-4	7,95

## Dimensions

## Dimensions – Coupling socket KD3, male thread

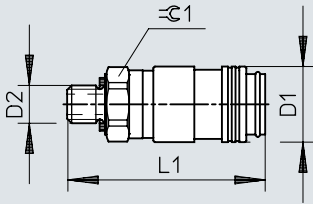
Download CAD data → [www.festo.com](http://www.festo.com)

	D1 ∅	D2	L1	±0.1
KD3-1/8-A	16	G1/8	36	14
KD3-1/4-A		G1/4	37,6	17

## Dimensions

### Dimensions – Coupling socket KD3, female thread

Download CAD data → [www.festo.com](http://www.festo.com)

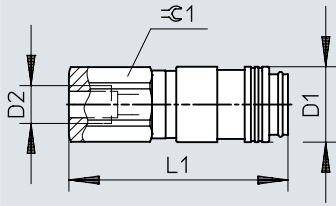

	D1 ∅	D2	L1	±0.1
KD3-1/8-l	16	G1/8	38,2	14
KD3-1/4-l		G1/4	45,2	17



## Dimensions

Dimensions – Coupling socket KD3, quick connector

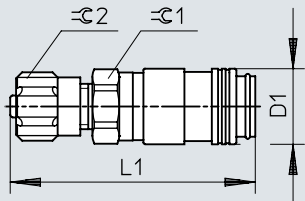
Download CAD data → [www.festo.com](http://www.festo.com)

	D1 ∅	L1	$\overline{C1}$	$\overline{C2}$
KD3-CK-4	16	43,1	14	12
KD3-CK-6		43,2		14

## Dimensions

### Dimensions – Quick coupling plug KS3, male thread

Download CAD data → [www.festo.com](http://www.festo.com)

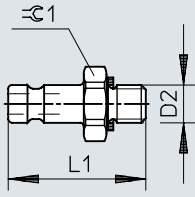

	D2	L1	⌀1
KS3-1/8-A	G1/8	25	13
KS3-1/4-A	G1/4	27,6	17

## Dimensions

Dimensions – Quick coupling plug KS3, female thread

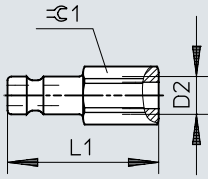
Download CAD data → [www.festo.com](http://www.festo.com)

	D2	L1	$\pm 0.1$
KS3-1/8-I	G1/8	28	13
KS3-1/4-I	G1/4	32,6	17

## Dimensions

Dimensions – Quick coupling plug KS3, quick connector

Download CAD data → [www.festo.com](http://www.festo.com)

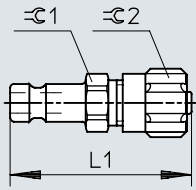

	L1	$\varnothing 1$	$\varnothing 2$
KS3-CK-4	34,5	12	12
KS3-CK-6	34,6	14	14

## Dimensions

Dimensions – Quick coupling plug KS3, insertion depth

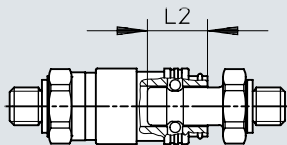
Download CAD data → [www.festo.com](http://www.festo.com)

	L2
KS3-1/8-A	13,6
KS3-1/4-A	13,6
KS3-1/8-I	13,6
KS3-1/4-I	13,6
KS3-CK-4	13,6
KS3-CK-6	13,6

## Dimensions

### Dimensions – Coupling socket KD4, male thread

Download CAD data → [www.festo.com](http://www.festo.com)

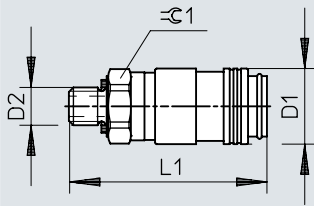

	D1 ∅	D2	L1	±0.1
KD4-1/4-A	26,4	G1/4	40,5	22
KD4-3/8-A		G3/8	41,5	
KD4-1/2-A		G1/2	43	24

## Dimensions

## Dimensions – Coupling socket KD4, female thread

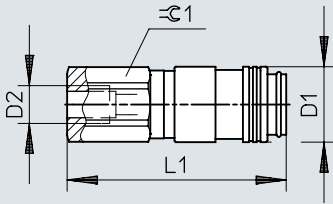
Download CAD data → [www.festo.com](http://www.festo.com)

	D1 ∅	D2	L1	±0.1
KD4-1/4-1	26,4	G1/4	46	22
KD4-3/8-1		G3/8	47,5	
KD4-1/2-1		G1/2	50,5	24

## Dimensions

### Dimensions – Coupling socket KD4, quick connector

Download CAD data → [www.festo.com](http://www.festo.com)

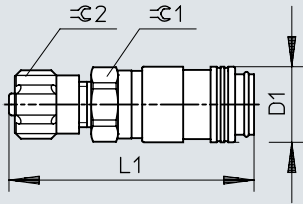

	D1 ø	L1	⊖ C 1	⊖ C 2
KD4-CK-6	26,4	46,4	22	14
KD4-CK-9		49,8		19



## Dimensions

## Dimensions – Coupling socket KD4, barbed fitting

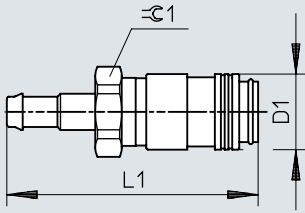
Download CAD data → [www.festo.com](http://www.festo.com)

	D1 ∅	L1	±0.1
KD4-N-9	26,4	56,2	21

## Dimensions

### Dimensions – Quick coupling plug KS4, male thread

Download CAD data → [www.festo.com](http://www.festo.com)

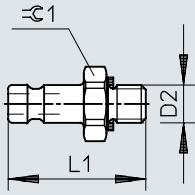

	D2	L1	$\approx 1^\circ$
KS4-1/4-A	G1/4	32,5	17
KS4-3/8-A	G3/8	34	19
KS4-1/2-A	G1/2	37,5	24

## Dimensions

## Dimensions – Quick coupling plug KS4, female thread

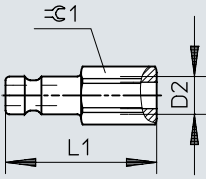
Download CAD data → [www.festo.com](http://www.festo.com)

	D2	L1	=C 1
KS4-1/4-1	G1/4	38,5	17
KS4-3/8-1	G3/8	39,5	19
KS4-1/2-1	G1/2	44	24

## Dimensions

### Dimensions – Quick coupling plug KS4, quick connector

Download CAD data → [www.festo.com](http://www.festo.com)

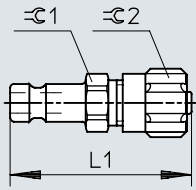

	L1	$\varnothing 1$	$\varnothing 2$
KS4-CK-4	40,2	17	12
KS4-CK-6	40,3		14
KS4-CK-9	43,7	19	19

## Dimensions

Dimensions – Quick coupling plug KS4, barbed fitting

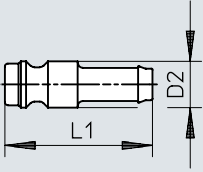
Download CAD data → [www.festo.com](http://www.festo.com)

	D2	L1
KS4-N-6	12	47
KS4-N-9		

## Dimensions

Dimensions – Quick coupling plug KS4, insertion depth

Download CAD data → [www.festo.com](http://www.festo.com)

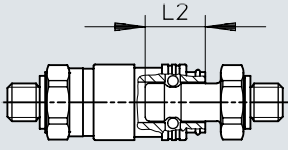

	L2
KS4-1/4-A	
KS4-3/8-A	14,95
KS4-1/2-A	
KS4-1/4-I	
KS4-3/8-I	14,95
KS4-1/2-I	
KS4-CK-4	
KS4-CK-6	14,95
KS4-CK-9	
KS4-N-6	
KS4-N-9	14,95

## Dimensions

Dimensions – Coupling socket KD...-R, male thread

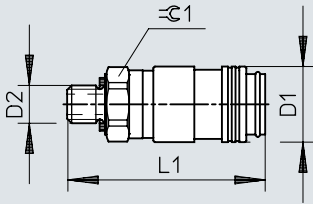
Download CAD data → [www.festo.com](http://www.festo.com)

	D1 ∅	D2	L1	±0.1
KD3-1/8-A-R	16	G1/8	36	14
KD4-1/4-A-R	26,4	G1/4	40,5	22

## Dimensions

### Dimensions – Quick coupling plug KS...-R

Download CAD data → [www.festo.com](http://www.festo.com)

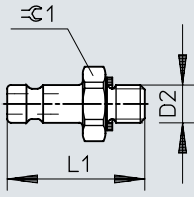

	D2	L1	∅ 1
KS3-1/8-A-R	G1/8	39,8	14
KS4-1/4-A-R	G1/4	42,5	22



## Dimensions

Dimensions – Push-in coupling KD...-R/KS...-R, insertion depth

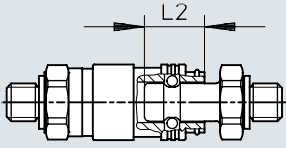
Download CAD data → [www.festo.com](http://www.festo.com)

	L2
KD3-1/8-A-R	13,6
KD4-1/4-A-R	14,95
KS3-1/8-A-R	13,6
KS4-1/4-A-R	14,95

## Dimensions

### Dimensions – Union nut MCK for quick connector

Download CAD data → [www.festo.com](http://www.festo.com)

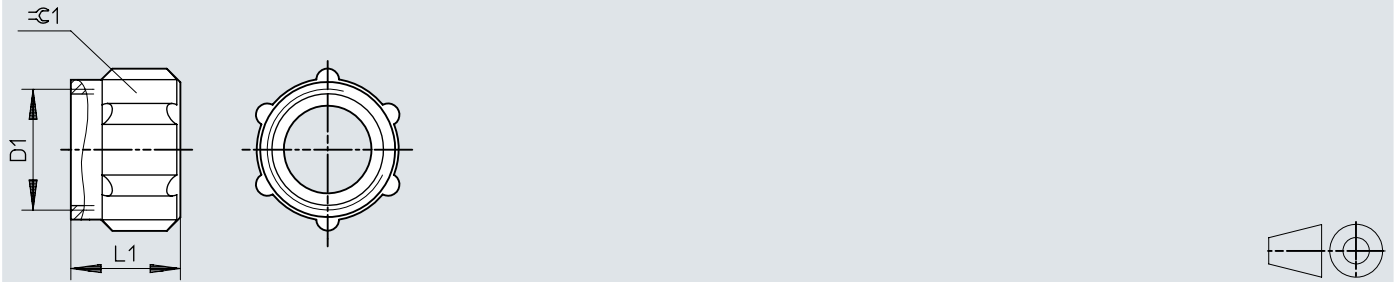

	D1	L1	$\text{C}1$
MCK-PK-3-KD	M6x0,75	8,5	8
MCK-PK-4-KD	M10x1	11	12
MCK-PK-6-KD	M12x1	11	14
MCK-PK-9-KD	M16x1	14,4	19

## Ordering data

Ordering data – Coupling sockets NPHS-D6-M (metal releasing sleeve)						
Short type code	Pneumatic connection, port 1	Standard nominal flow rate	Nominal flow rate standardised according to ISO 8778	Product weight	Part no.	Type
KD1	Male thread M3	44 l/min	47.7 l/min	2.9 g	151995	KD1-M3-A
KS1	Barbed hose fitting 2 mm			0.4 g	151996	KS1-CN-2

Ordering data – Coupling sockets NPHS-D6-M (metal releasing sleeve)						
Short type code	Pneumatic connection, port 1	Standard nominal flow rate	Nominal flow rate standardised according to ISO 8778	Product weight	Part no.	Type
KD2	Male thread M5	83 ... 131 l/min	90 ... 142 l/min	10 g	4087	KD2-M5-A
	Female thread M5	84 ... 135 l/min	91.1 ... 146.3 l/min	12 g	531620	KD2-M5-I
	For tubing outer diameter of 4 mm, For barbed fitting I.D. 3 mm with union nut	68 ... 88 l/min	73.7 ... 95.4 l/min	11 g	531621	KD2-CK-3
	CK-4, For barbed fitting I.D. 4 mm with union nut	82 ... 130 l/min	88.9 ... 140.9 l/min	16 g	531622	KD2-CK-4
KS2	Male thread M5	85 ... 136 l/min	92.1 ... 147.4 l/min	5 g	531658	KS2-M5-A
	Female thread M5	88 ... 139 l/min	95.4 ... 150.7 l/min		531660	KS2-M5-I
	For tubing outer diameter of 4 mm, For barbed fitting I.D. 3 mm with union nut	68 ... 84 l/min	73.7 ... 91.1 l/min	4 g	4091	KS2-CK-3
	For tubing outside diameter of 6 mm, For barbed fitting I.D. 4 mm with union nut	86 ... 129 l/min	93.2 ... 139.8 l/min	11 g	4090	KS2-CK-4

Ordering data – Coupling sockets NPHS-D6-M (metal releasing sleeve)						
Short type code	Pneumatic connection, port 1	Standard nominal flow rate	Nominal flow rate standardised according to ISO 8778	Product weight	Part no.	Type
KD3	Male thread G1/8			28 g	531659	KD3-1/8-A-R
		185 ... 572 l/min	200.5 ... 620 l/min		2142	KD3-1/8-A
	Male thread G1/4	185 ... 594 l/min	200.5 ... 643.9 l/min	35 g	531626	KD3-1/4-A
	Female thread G1/8	185 ... 603 l/min	200.5 ... 653.7 l/min	32 g	531627	KD3-1/8-I
	Female thread G1/4	185 ... 666 l/min	200.5 ... 721.9 l/min	47 g	531628	KD3-1/4-I
	For tubing outside diameter of 6 mm, For barbed fitting I.D. 4 mm with union nut	158 ... 225 l/min	171.3 ... 243.9 l/min	31 g	531629	KD3-CK-4
	For tubing outer diameter of 8 mm, For barbed fitting I.D. 6 mm with union nut	180 ... 468 l/min	195.1 ... 507.3 l/min	32 g	531630	KD3-CK-6
KS3	Male thread G1/8				531667	KS3-1/8-A-R
		225 ... 648 l/min	243.9 ... 702.4 l/min	13 g	3492	KS3-1/8-A
	Male thread G1/4	225 ... 653 l/min	243.9 ... 707.9 l/min	23 g	531666	KS3-1/4-A
	Female thread G1/8	225 ... 617 l/min	243.9 ... 668.8 l/min	16 g	531668	KS3-1/8-I
	Female thread G1/4	225 ... 666 l/min	243.9 ... 721.9 l/min	27 g	531669	KS3-1/4-I
	CK-4, For barbed fitting I.D. 4 mm with union nut	158 ... 185 l/min	171.3 ... 200.5 l/min	16 g	3326	KS3-CK-4
	For tubing outer diameter of 8 mm, For barbed fitting I.D. 6 mm with union nut	216 ... 464 l/min	234.1 ... 503 l/min	21 g	3478	KS3-CK-6

## Ordering data

Ordering data – Coupling sockets NPHS-D6-M (metal releasing sleeve)						
Short type code	Pneumatic connection, port 1	Standard nominal flow rate	Nominal flow rate standardised according to ISO 8778	Product weight	Part no.	Type
KD4	Male thread G1/4	261 ... 1287 l/min	282.9 ... 1395.1 l/min	57 g	2143	KD4-1/4-A
		765 l/min	829.3 l/min	58 g	531694	KD4-1/4-A-R
	Male thread G3/8	261 ... 1274 l/min	282.9 ... 1381 l/min	62 g	2144	KD4-3/8-A
	Male thread G1/2	257 ... 1337 l/min	278.6 ... 1449.3 l/min	78 g	2145	KD4-1/2-A
	Female thread G1/4	257 ... 1292 l/min	278.6 ... 1400.5 l/min	88 g	531636	KD4-1/4-I
	Female thread G3/8	261 ... 1350 l/min	282.9 ... 1463.4 l/min	82 g	531637	KD4-3/8-I
	Female thread G1/2	257 ... 1332 l/min	278.6 ... 1443.9 l/min	86 g	531638	KD4-1/2-I
	For tubing outer diameter of 8 mm, For barbed fitting I.D. 6 mm with union nut	252 ... 756 l/min	273.2 ... 819.5 l/min	63 g	531639	KD4-CK-6
	For barbed fitting inside diameter of 9 mm with union nut	261 ... 1116 l/min	282.9 ... 1209.7 l/min	71 g	531640	KD4-CK-9
	Barbed hose fitting 9 mm	810 ... 1152 l/min	878 ... 1248.8 l/min	57 g	531641	KD4-N-9
KS4	Male thread G1/4	756 ... 1323 l/min	819.5 ... 1434.1 l/min	21 g	2154	KS4-1/4-A
		765 l/min	829.3 l/min	46 g	531677	KS4-1/4-A-R
	Male thread G3/8	756 ... 1323 l/min	819.5 ... 1434.1 l/min	29 g	2155	KS4-3/8-A
	Male thread G1/2			55 g	531676	KS4-1/2-A
	Female thread G1/4	720 ... 1161 l/min	780.5 ... 1258.5 l/min	31 g	531678	KS4-1/4-I
	Female thread G3/8	756 ... 1350 l/min	819.5 ... 1463.4 l/min	32 g	531679	KS4-3/8-I
	Female thread G1/2	756 ... 1314 l/min	819.5 ... 1424.4 l/min	57 g	531680	KS4-1/2-I
	For tubing outside diameter of 6 mm, For barbed fitting I.D. 4 mm with union nut	252 ... 261 l/min	273.2 ... 282.9 l/min	26 g	2150	KS4-CK-4
	For tubing outer diameter of 8 mm, For barbed fitting I.D. 6 mm with union nut	432 ... 495 l/min	468.3 ... 536.6 l/min		2151	KS4-CK-6
	For barbed fitting inside diameter of 9 mm with union nut	725 ... 1197 l/min	785.9 ... 1297.5 l/min		531683	KS4-CK-9
	Barbed hose fitting 6 mm	441 ... 495 l/min	478 ... 536.6 l/min	15 g	2152	KS4-N-6
	Barbed hose fitting 9 mm	711 ... 1134 l/min	770.7 ... 1229.3 l/min	18 g	2153	KS4-N-9

Ordering data – Coupling sockets NPHS-D6-M (metal releasing sleeve)						
Short type code	Pneumatic connection, port 1	Standard nominal flow rate	Nominal flow rate standardised according to ISO 8778	Product weight	Part no.	Type
KD3	Male thread G1/8			28 g	531659	KD3-1/8-A-R
KD4	Male thread G1/4	765 l/min	829.3 l/min	58 g	531694	KD4-1/4-A-R
KS3	Male thread G1/8			32 g	531667	KS3-1/8-A-R
KS4	Male thread G1/4	765 l/min	829.3 l/min	46 g	531677	KS4-1/4-A-R

## Accessories

Union nut MCK			
	Short type code	Part no.	Type
	MCK	533674	MCK-PK-6-KD
		533673	MCK-PK-4-KD
		533675	MCK-PK-9-KD
		533672	MCK-PK-3-KD